

☐Urgent ☐Return receipt ☐Expand Group ☐Restricted ☐Prevent Copy

Emily Tsz Yan WONG/PLAND

寄件者: tmylwdpo_pd/PLAND
寄件日期: 2026年01月15日星期四 16:40
副本: Emily Tsz Yan WONG/PLAND
主旨: 轉寄: A/YL-TYST/1327
附件: A_YL-TYST_1327.pdf; Plans.pdf

類別: 橘色類別

From: tpbpd/PLAND <tpbpd@pland.gov.hk>
Sent: Thursday, January 15, 2026 4:34 PM
To: tmylwdpo_pd/PLAND <tmylwdpo@pland.gov.hk>
Cc: Kiff Kit Fu YIU/PLAND <kkfyiu@pland.gov.hk>
Subject: Fw: A/YL-TYST/1327

From: pang hingyeun [REDACTED]
Sent: Thursday, January 15, 2026 3:32 PM
To: tpbpd/PLAND <tpbpd@pland.gov.hk>; Jethro Ka Lok FUNG/PLAND <jklfung1@pland.gov.hk>
Subject: A/YL-TYST/1327

Dear Sir/Madam,

We are attaching further information and plans for your reference and record.
Thank You !

Regards,
H.Y.Pang

從 [Outlook](#) 傳送

1. The government is developing the Northern Metropolis, and in the case of Hung Shui Kiu, it has expropriated most of our land for the construction of reservoirs and roads.
2. Our application is located on lot 1829 S.A ss.2 RP, with a total land area of approximately 84,000 square meters. 95 % of this lot is situated in a green belt zone, while the remaining 5% is designated for Open Space use.
3. The government has requisitioned about 60,000 square meters of our land for the construction of a reservoir as part of the development of Hung Shui Kiu.
4. We only have this 5 % of the land, which is more suitable for constructing the new ancestral hall.
5. Given that our old ancestral hall is located nearby, we also hope to relocate it to a nearby location. Due to feng shui considerations, we also hope that the orientation of the new ancestral hall will be the same as the old one.
6. Since our site selection requires family consent, we ultimately decided that the ancestral hall can only be built on this lot.
7. Additionally, considering that the current location is close to the future entrance reserved for the new road construction, therefore, we have decided to relocate the ancestral hall to the currently proposed location.
8. Due to the owner's request of Lot 472 RP that our application site must be at least three meters or above away from that lot, we chose the current location.
9. Currently, we have a vehicular road that accesses the application site. If future development leads to the termination of that road, we will only use the designated entrance of the newly constructed road to access the application site.
10. The remaining land we have is mostly planted with trees, while the application site has no trees and is also relatively flat.
11. Please refer to the Reserved Entrance and Exit Plan.
12. Please refer to the Site Plan.
13. The ancestral hall will not be used as a columbarium, it will only store the spirit tablets of our family ancestors.
14. We will fill the applied area with sand, gravel and soid, and then lay concrete on top.
15. The owner established the Chan Wai-Chau married couple memorial garden 40 years ago. At that time, to beautify the park, the owner purchased 3,000 trees to be planted within the park and on the hills, and hired staff to manage the park. The application site does not have any trees; however, if other government projects necessitate the relocation of certain trees, we will send staff to move those trees to remaining areas of the park.

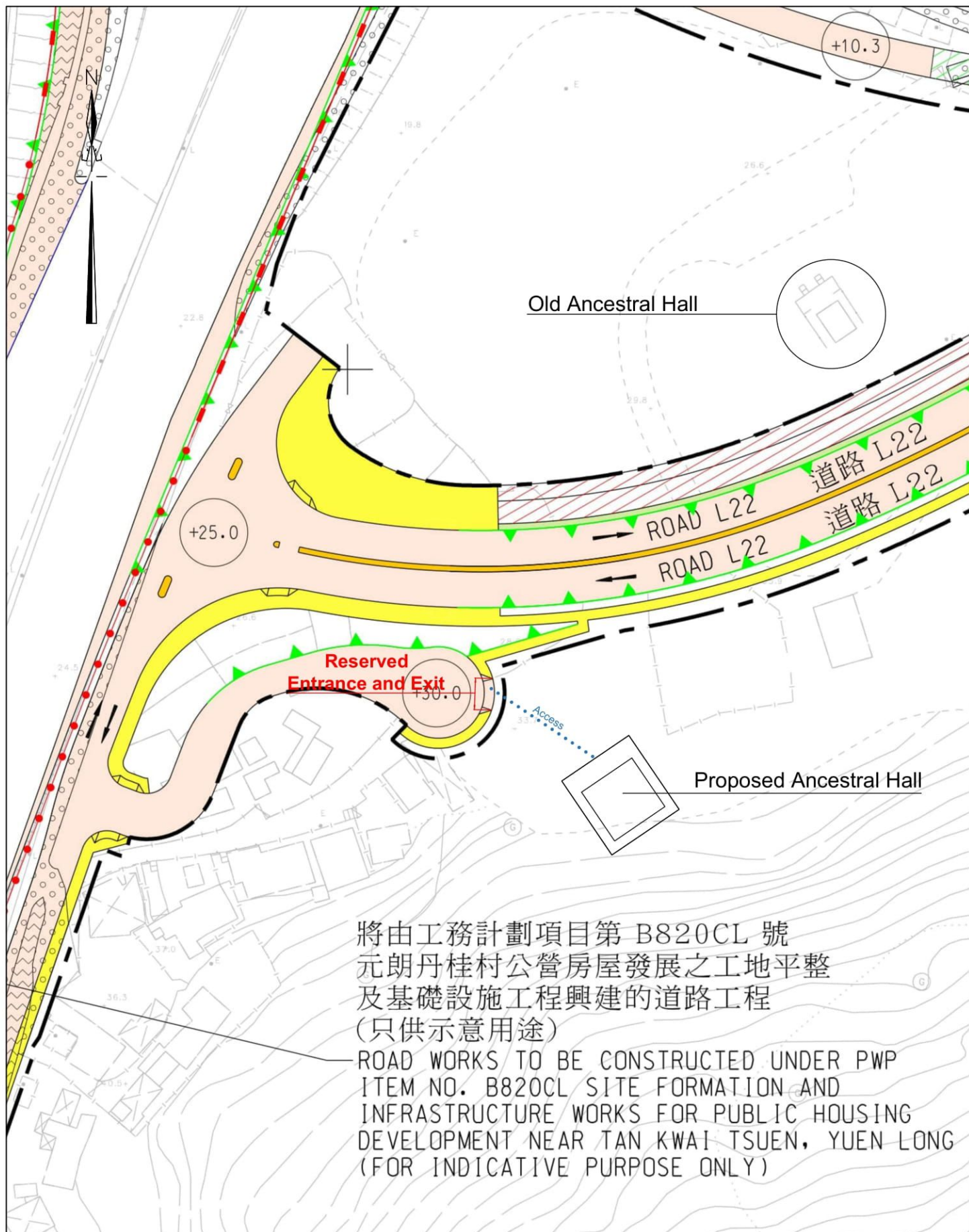

Project Title :	Scale : 1 : 1000	Plan No. : CW/1829A2RP/121/RE
Proposed Ancestral Hall	Date : 26-12-2025	Survey Sheet No. : 6-NW-18A & 6-NW-18C
Drawing Title : Reserved Entrance and Exit (D.D. 121 Lot No. 1829 S.A ss.2 RP (Part))	卓 弘 測 量 服 務 公 司 CHUO WANG SURVEY SERVICES COMPANY 1/F, Block A, Wo Tai Building, No. 2-24, Wo Tai Street, Luen Wo Hui, Fanling, N.T. Telephone : 26831600 Mobile : 66862836 Fax : 26831380 E-mail - chuowang.ssc@gmail.com / h.y.pang@hotmail.com	

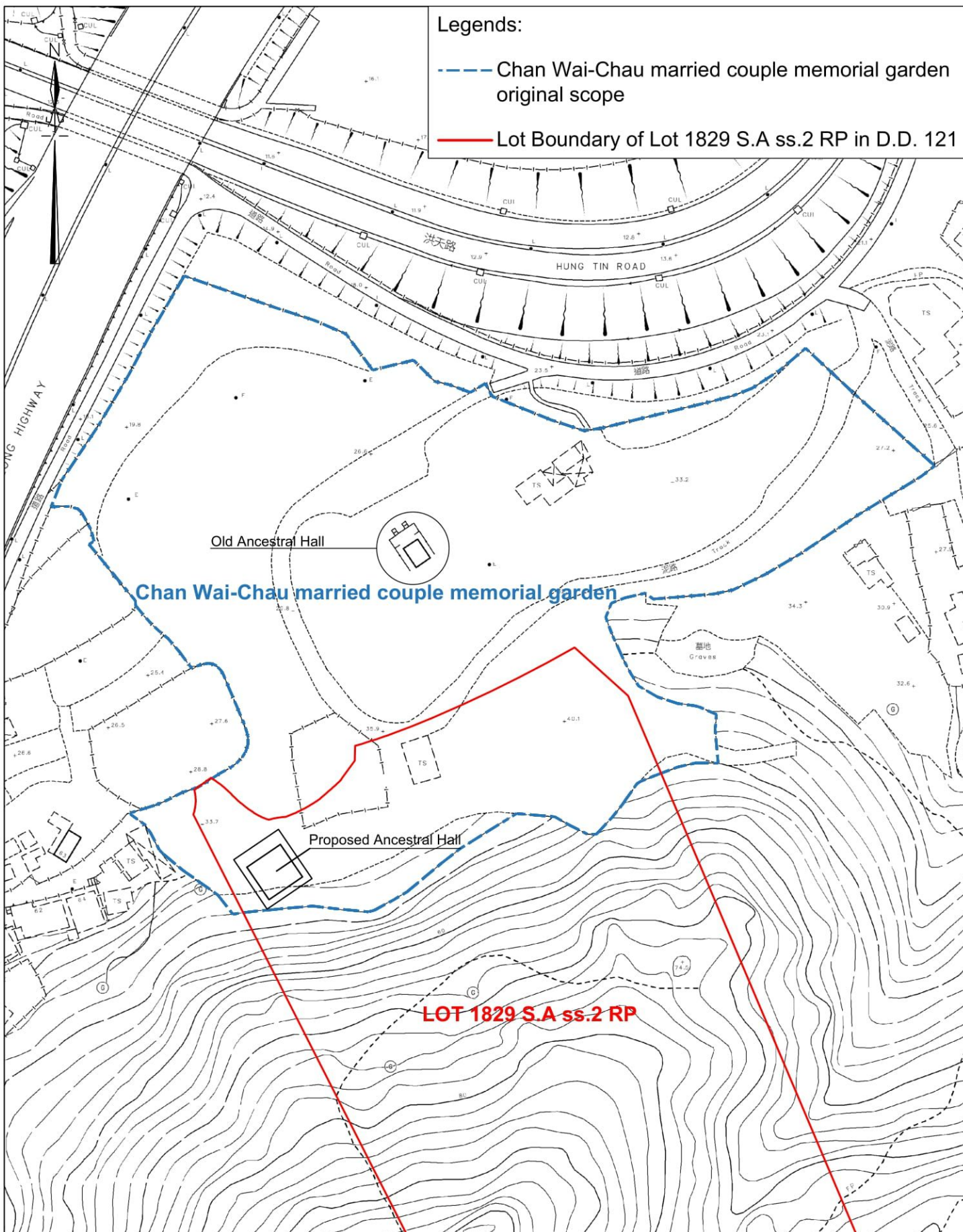

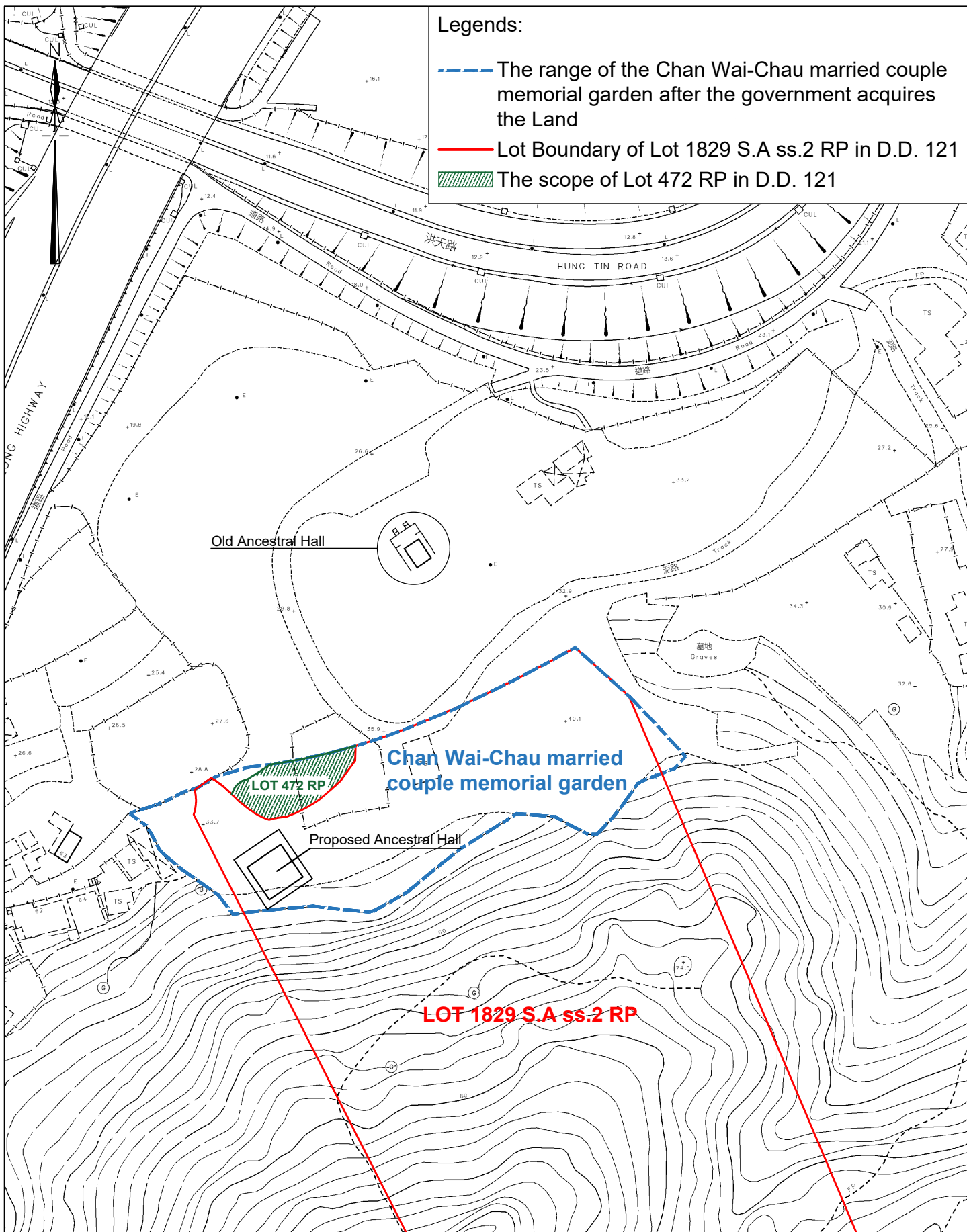

Project Title :	Scale : 1 : 1500	Plan No. : CW/1829A2RP/121/SP1
Proposed Ancestral Hall	Date : 26-12-2025	Survey Sheet No. : 6-NW-18A & 6-NW-18C
Drawing Title : Site Plan (D.D. 121 Lot No. 1829 S.A ss.2 RP (Part))	卓 弘 測 量 服 務 公 司 CHUO WANG SURVEY SERVICES COMPANY 1/F, Block A, Wo Tai Building, No. 2-24, Wo Tai Street, Luen Wo Hui, Fanling, N.T. Telephone : 26831600 Mobile : 66862836 Fax : 26831380 E-mail - chuowang.ssc@gmail.com / h.y.pang@hotmail.com	